

**ONGA®**

## 12 SERIES

### MOULDED WATER TRANSFER PUMPS

### CENTRIFUGAL PUMPS



122



#### FEATURES

High grade corrosion resistant moulded construction.

Open designed impeller.

Strong and durable construction.

Max. head - 20m.

Max. flow - 280lpm.

#### APPLICATIONS

- Domestic, industrial or rural water transfer pump including grey water.
- Sump emptying.
- Effluent transfer.
- Hydroponics.
- Fountains and waterfalls.

#### PUMP INFORMATION

Horizontal, single-stage, surface mounted centrifugal pump with open impeller coupled to a cool running Totally Enclosed Fan Cooled 2 pole motor with external thermal overload (single phase only, three phase units require separate quick trip overload supplied by electrical contactor).

#### OPERATING CONDITIONS

Suitable for pumping clean, grey and effluent water.

Fluid:	Water.
Maximum water temperature:	70°C.
Minimum water temperature:	1°C.
Maximum ambient temperature:	55°C.
Maximum working pressure:	350kPa.

## ELECTRICAL DATA

Type	Type of current	Voltage ± 10%	Frequency Hz	Motor rating kW	Nominal RPM	Current Ampere	Locked rotor current	Motor protection	Insulation class	IP rating
				P2						
121	1-phase	230	50	1.1	2900	10.8 A	38.8 A	Auto	B	IP44
122	1-phase	230	50	1.1	2900	10.8 A	38.8 A	Auto	B	IP44
122	3-phase	400	50	1.1	2900	3.3 A	23.6 A	-	B	IP44

## PERFORMANCE

Type	P/No	Delivery head H [m]	5	10	15	20
			Capacity [litres per minute]	213	144	30
121	312100	Capacity [litres per minute]	213	144	30	-
122	312200 / 312230		262	204	129	17

## PERFORMANCE CURVE

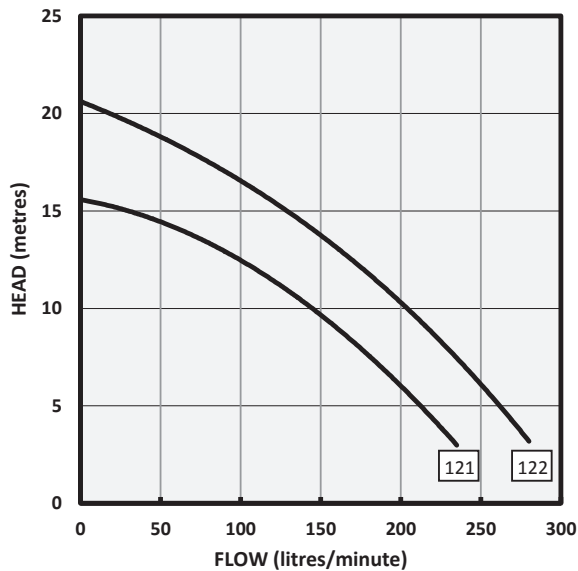

## NPSHR

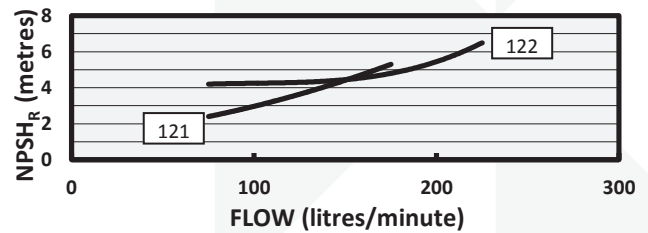

## PUMP CONSTRUCTION MATERIALS

Component	Material
Pump casing	20% Glass Filled ABS
Baffle	20% Glass Filled Nylon
Priming cap	Acetyl
Impeller	20% Glass Filled Polycarbonate
Diffuser	20% Glass Filled Nylon
Shaft sleeve	Stainless Steel
Seal flexible bellows	Nitrile
Seal stationary face	Ceramic
Seal rotating face	Carbon
Seal spring	304 Stainless Steel
Motor shaft	Mild Steel
O'Rings	Nitrile

## DIMENSIONS

Type	Pump inlet	Pump outlet	Carton L x W x H	Packed weight
121	1½" BSP (male)	1¼" BSP (male)	590 x 290 x 340 mm	14 kg
122/1	1½" BSP (male)	1¼" BSP (male)	590 x 290 x 340 mm	14 kg
122/3	1½" BSP (male)	1¼" BSP (male)	590 x 290 x 340 mm	17 kg

### Single phase

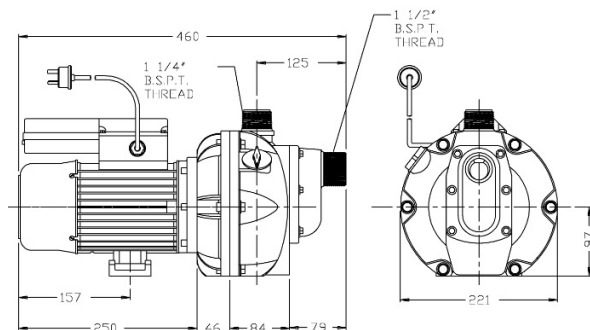

### Three phase

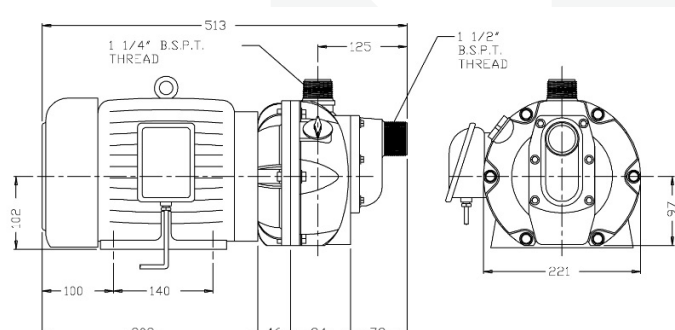

Head Office Pentair AU/NZ: 1-21 Monash Drive, Dandenong South, VIC 3175, Australia. [www.pentair.com.au](http://www.pentair.com.au)

All Pentair trademarks and logos are owned by Pentair, Ltd. All other brand or product names are trademarks or registered marks of their respective owners. Because we are continuously improving our products and services, Pentair reserves the right to change specifications without prior notice.

Pentair is an equal opportunity employer.

ABN 27 004 856 204 © 2012 Pentair, Ltd. All Rights Reserved.

© 2015 Pentair